

QUESTIONS & ANSWERS

WEBINAR: MODERN COMMERCIAL FENCING SYSTEMS: IMPROVED SECURITY MEETS BEST-IN-CLASS AESTHETICS

1. Q: Is there any practical defence against cutting torches and acids?

A: We are in the process of testing the Fortress® ARES™ High Security Fence to ASTM Standard F2781. This standard tests 35 different tools for forced entry. An Oxyacetalene torch is included in this standard, but no acids are included.

2. Q: What does the C channel look like on the fence?

A:

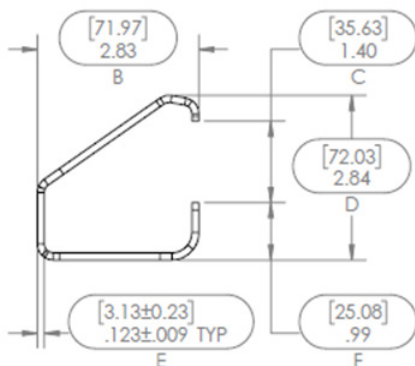

3. Q: Does gloss improve cleanability?

A: The Gloss Black powder coat that we utilize is definitely easier to clean than our Black Sand powder coat. In the next couple of weeks, we will be publishing a new Product Care and Cleaning document on our website. The following link will take you directly to the page where this resource will live: www.fortressbp.com/maintenance-care



4. Q: What is the cost per LF for the steel/aluminium fencing?

A: From a material cost perspective, steel is generally 30% more than aluminium fence.

5. Q: Does Fortress® offer wood and/or composite fencing?

A: Fortress® does offer two different types of composite products. Both products are a bamboo based, sustainable product.

Oasis is a non-capped, cedar fence substitute in heights of 6' and 8' that is intended for vertical installation. Oasis is a vertical product.

Evolver is a horizontal, capped product that is designed to be installed on a solid surface such as concrete or a deck.

www.fortressbp.com/fencing/composite



6. Q: Do you have a close-up photo or cross-section detail of a pale?

A:

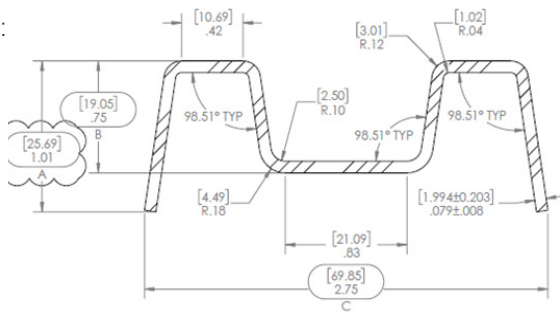

7. Q: Do you have pics of where pickets follow contour grade and still vertical?

A:

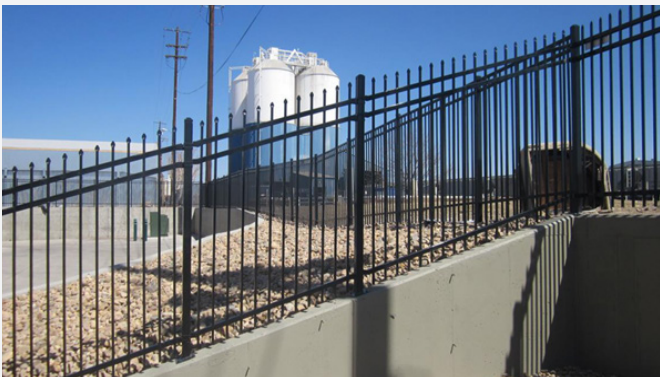

8. Q: Does Fortress® offer any commercial vinyl products?

A: No, we do not have any vinyl products in our portfolio.

9. Q: Do you have any photos of what you consider biophilic design fit with fencing?

A: Unfortunately, we do not currently have any photos available to answer this question.

10. Q: What are the maximum and minimum costs for high security fencing?

A: The Fortress® ARES™ High Security product is available in heights from 70" to 142". Based upon an estimated linear foot cost basis, a 70" tall product would average \$250.00 per foot, installed. The max would be a 142" tall product with an average per linear foot cost of \$509.00.

11. Q: How does commercial fencing qualify under the Unified Facilities Criteria of the DOD?

A: Unfortunately, we do not have a response to this question at this time. In the near future, after further researching the qualifications, we will be able to provide a response.

12. Q: Can you provide a review of gates - sliding, folding, swing?

A: Fortress® offers a full line of Swing, V-track and Cantilever gates. Please review the following link for additional information on our gate offering.

www.fortressbp.com/fencing/custom-gates



13. Q: Can you shown an image of the C channel for high security fences?

A:

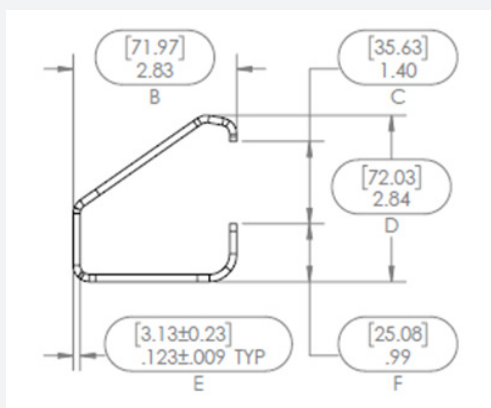

14. Q: Do you recommend slotted anchors?

A: We do not have a specific anchor bolt specification.

15. Q: Can decorative and/or green panels be added to the fencing?

A: At this time, we do not offer any decorative or green products.

16. Q: How do you integrate a ground anchored integral cable installed at approximately the mid height of the steel high security system? Is it furnished with the fence turn key, or a separate subcontractor?

A: Currently, the Fortress® ARES™ High Security fence product does not offer a cable barrier option. However, that product addition is in the development process. The plan is to offer the steel cable as a part of the fence. Traditionally, the contractor would be responsible for the turnkey solution, with Fortress providing the fence materials.

17. Q: We'll be looking to spec a fence to separate a historic railroad depot building from the nearby active railroad main line. The building is to be repurposed for non-railroad operations. Aesthetics are critical as is security. A solid wall would be undesirable because it would create a "canyon" effect between the rail line and the depot building arcade.

A: Without knowing all of the details of this project, I suggest either the V2 Commercial product, the V3 Industrial product, or the Titan Industrial product. For fence panels heights over 94", the Titan product would be needed. For additional technical support, product drawings, specifications or submittal packages, please submit an email to specifications@fortressbp.com.



18. Q: Is there a height limitation for composite fencing? And, what is the cost comparison to rackable steel fencing?

A: The current Fortress composite fence offering is limited to 6' and 8' for the Oasis product. The Evolver product is only available in a 6' height.

For a cost comparison, I will assume that the comparison would be between a commercial/industrial steel product and the Oasis composite product. Commercial steel fence would be approximately 15-20% more than the Oasis composite fence. Industrial steel fence would be approximately 25-30% more than the Oasis product.

19. Q: What are the recommended heights for different applications - pools, daycare or preschools, government buildings?

A: For pools, daycare facilities and preschool, I suggest using the National Pool Code as the basis of design. There are multiple resources available online for the BOCA pool codes.

Each government agency would most likely have their own specification for a fence height, depending on what the fence is protecting. As a suggestion only, the minimum height would start at a 70" tall commercial or industrial fence product.

20. Q: Are post spacings variable across a long run or is it common to do all 8' spacing, for example, with the ends being where variations are made up?

A: For Fortress® products, the fence post spacing should be consistent across long runs based upon our standard panel with of 90.5", or 94" on center post spacing. In my opinion, I would minimize panel trimming, to make up any variations, at corners or sections that have a lower visibility.

21. Q: What are restrictions on sizes for panel widths and heights?

A: Fortress® fence products have a standard width of 90.5" and heights that range from 34" up to 94". The Titan Industrial product can achieve heights up to 159".

22. Q: Can you discuss the integration of vehicle and pedestrian gates?

A: We are currently developing our product offering for vehicle and pedestrian gates in conjunction with our cable barrier version of the ARES™ High Security Fence and more information will be available at a later date.

